



Greta Meeting

Greta Meeting

Greta carries the spirit of the 60's with its retro lines to today and integrating the past with the future. It adapts to any environment with its wide product range in harmony. Greta Meeting is combination of two Greta High Backrest sofas through a mid-panel that can be also a media wall with NurusLinks® when electrification and screen options added. NurusLinks®, exclusive to Nurus products, is a fine way to match your electronics to your furniture. Quick and accurate charging abilities coupled with multimedia extensions bring speed and ease into daily operations.

Greta Meeting also carries the advantages of Greta High Backrest sofas; while the backrest helps sheltering, its soft quilted fabric provides noise isolation supporting privacy. While allowing effective construction of limited spaces, Greta Meeting meets all needs of a meeting room without walls. It provides high concentration with high functionality through technology and accessory support.

Available with double or triple sofas, Greta Meeting can also be combined with movable service coffee table to increase comfort during the use.

Designed by Nurus D Lab

Nurus D Lab, always up to date with both scientific and technological developments; designs products that are ahead of their time by observing the needs of users and listening to their dreams. The end product that is presented to the user is the best one among countless options, emerging from brilliant ideas. Nurus D Lab manages all the steps that are taken from setting the brand's design strategy to the market launch.

nurus links®

High concentration, high functionality...



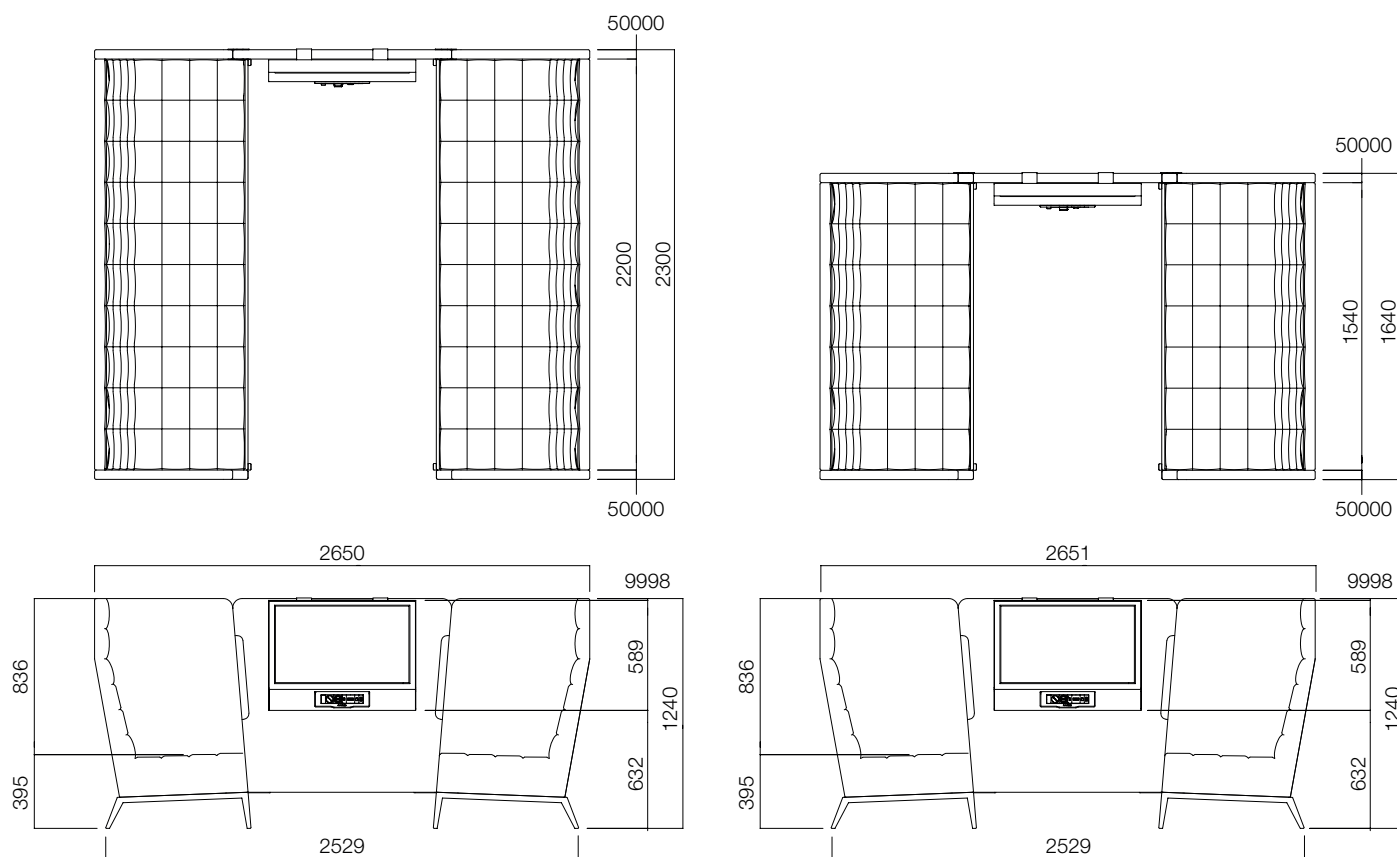

Dimensions defined in millimeters.

Design

Nurus D Lab

Materials

Legs come with powder coated options, upholstery is available in different materials*.

Fabric

Upholstery available in fabric, leather and eco-leather*.

* Please refer to material box.